

Supports



Mounting assemblies, base spacers, handles, bearing units, handles the guides and sensors, and many other parts to allow fast and easy installation internal line transport.

Safety protection

Guards to protect the moving parts dangerous for the employee, such as mudguards and propulsion systems, shield bearings, tip protection guides (including roller) or hand protectors in accordance with Directive 2006/42 / CE.



Varius

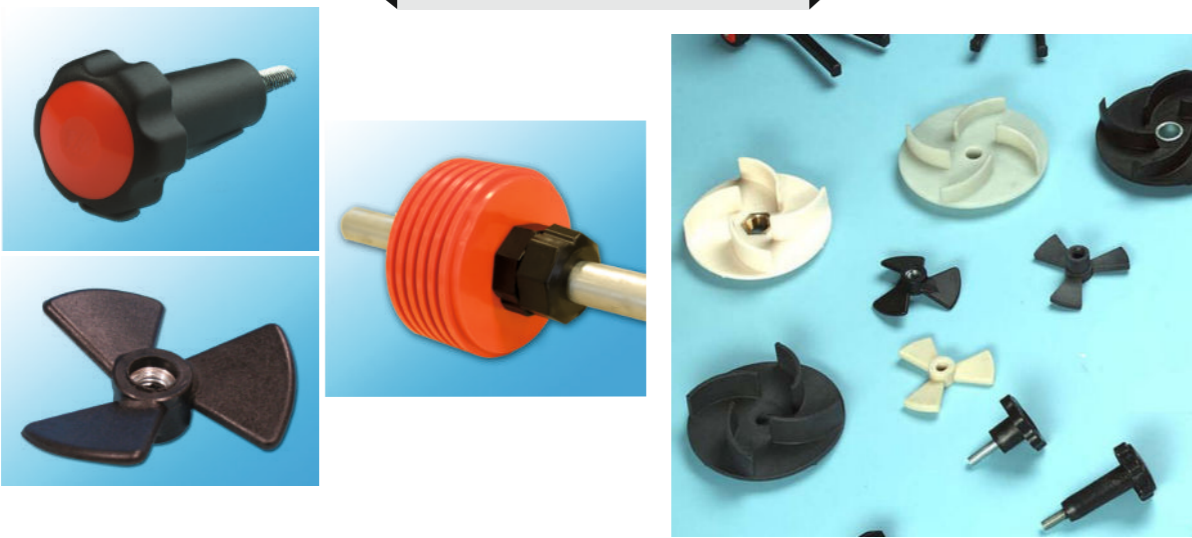

ACCESSORIES • SAFETY



PLASTIC PARTS
FOR PRODUCTIONS LINES
AND MAINTENANCE



Link chains



Link chains are used in the construction of internal transport conveyors. They are used in many industries in particular in the food and chemical industries where hygiene production is very important. Chains are characterized by the low noise operation and are most often used for transporting fragile products: cartons, bottles of glass and PET, cans, packaging, cosmetics and food products.

Green blow - centrifugal blowers

Blowers in plastic material that can also be used in many other industrial sectors when it is necessary to cool, clean items or devices. They are available in different configurations of motors, blowing nozzles, fixing supports, in order to respond adequately to all needs. Silent and light, all blowers are CE marked.

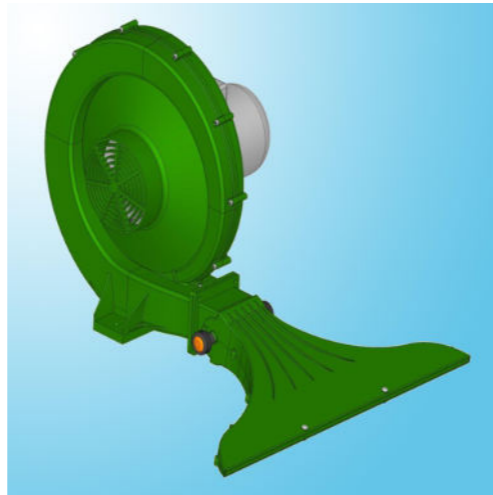

Roller Conveyors



Thanks to modularity and "easy assembly", they can be quickly applied on all handling systems. Roller Conveyors are equipped with different types of aluminum profile and various types of rollers in order to meet different needs, both constructive and flow. Accessories that facilitate their use complete the range.

LINK CHAINS • BLOW •

Disk Packs

A wide range of sets of disk packs to meet all the requirements. Explored in various ways to ensure that the customer obtain the desired aesthetic effect depending on the enamel, cabins and sprayed material.



Gate valves



Thermoplastic gate valves, for controlling the air flow controls may be controlled by means of a graduated scale printed on the valve and held in this state by means of nuts and bolts. Available in diameter air duct 80-90-100-120-150mm. The flapper valve is, however, typical for central dedusting systems of industrial, for cables with a diameter of 50 and 60 mm. An additional feature of this valve is threaded G2 "inside the body, which allows screwing it directly to the suction hose.

Pulleys & Rolls

Made of thermoplastic material, thanks to their particular plastic composition, with consequent lower maintenance and downtime for replacement. Available in different diameters and cross-sections of the profile strips and used bearings and internal holes.

